



LONDON
SQUARE

WATFORD

WD24

THE TRAFALGAR

2 BEDROOM APARTMENT
Plot 10



| | | |
|----------------------------|---------------|----------------|
| Kitchen/Living/Dining Room | 7.65m x 3.32m | 25'1" x 10'11" |
| Bedroom 1 | 4.50m x 2.70m | 14'9" x 8'10" |
| Bedroom 2 | 4.50m x 2.50m | 14'9" x 8'2" |

- | | | |
|-----------------------|-----------------------------|-------|
| * Handed Plots | W = Included Wardrobe | — |
| ST = Store | W = Optional Wardrobe | - - - |
| TD = Tumble Dryer | WM = Washing Machine | |
| RL = Roof Light | HW Cyl = Hot Water Cylinder | |
| SC = Service Cupboard | CS = Cycle Store | |
| RS = Refuse storage | | |

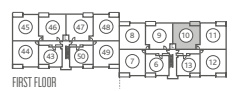
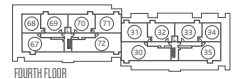

Floorplans are not to scale, dimensions may vary between plots and kitchen layouts are indicative only. Please speak to your Sales Advisor for details.

➤ YOUR CLOSEST BUS STOP IS A 1 MINUTE WALK THAT CAN TAKE YOU TO WATFORD TOWN CENTRE IN 19 MINUTES.

