

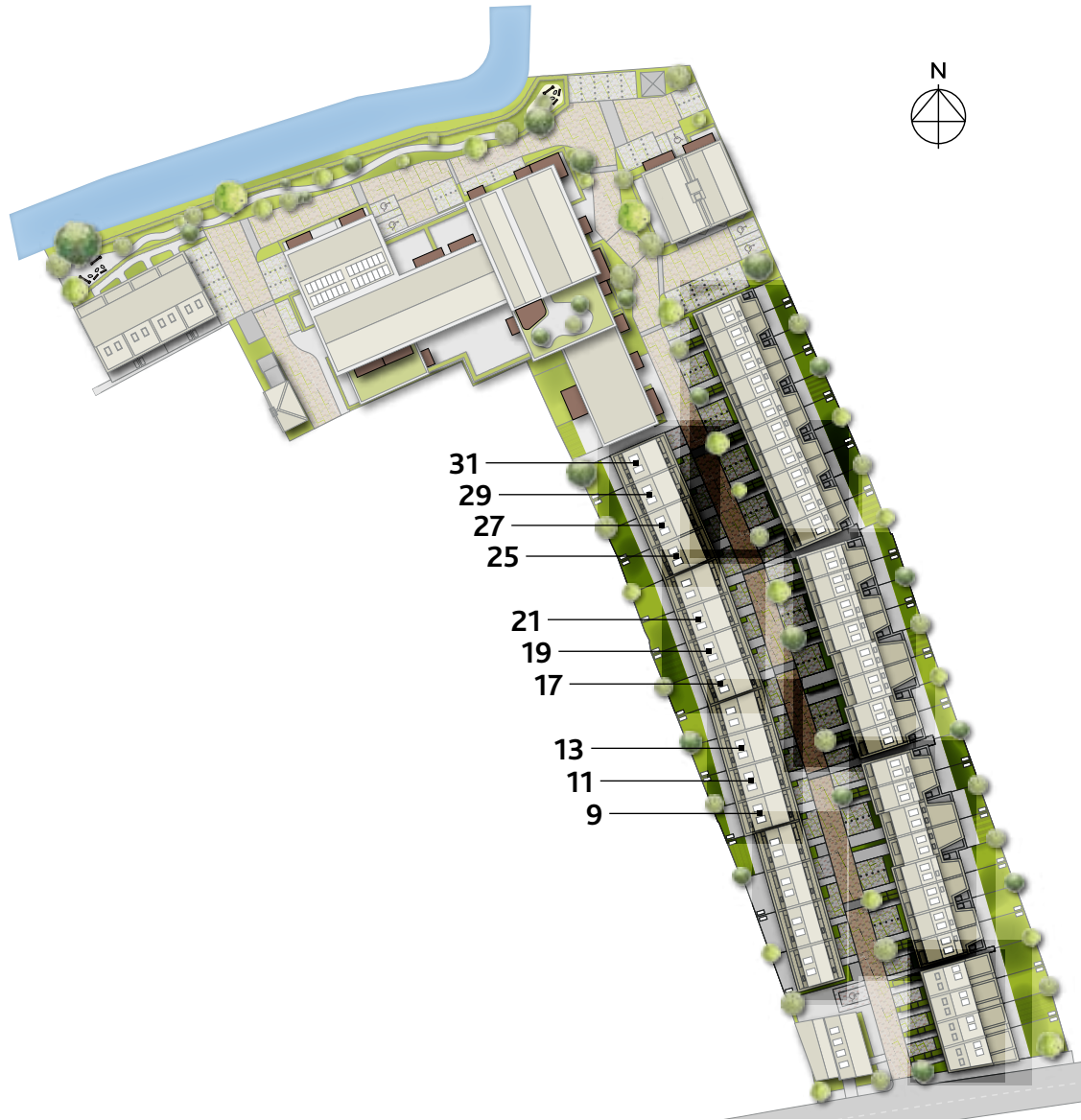

THREE BEDROOM HOUSE

THE CORNFLOWER

NUMBERS
9, 11, 13, 17, 19, 21,
25, 27, 29 & 31



ROOM DIMENSIONS

Ground Floor		
Kitchen / Living / Dining	5.55m x 3.14m	18'2" x 10'4"
First Floor		
Living Room	5.55m x 3.55m	18'2" x 11'8"
Bedroom 1	3.86m x 3.55m	12'8" x 11'8"
Second Floor		
Bedroom 2	4.15m x 2.70m	13'7" x 8'10"
Bedroom 3	4.71m x 2.53m	15'5" x 8'3"

Floorplans shown are for approximate measurements only. Exact layouts and sizes may vary. The dimensions shown are accurate to within a tolerance of +/-50mm, they are not intended to be used for carpet sizes, appliances, spaces or items of furniture. Furniture and kitchen layouts are indicative only. Please ask a Sales Consultant for further information.

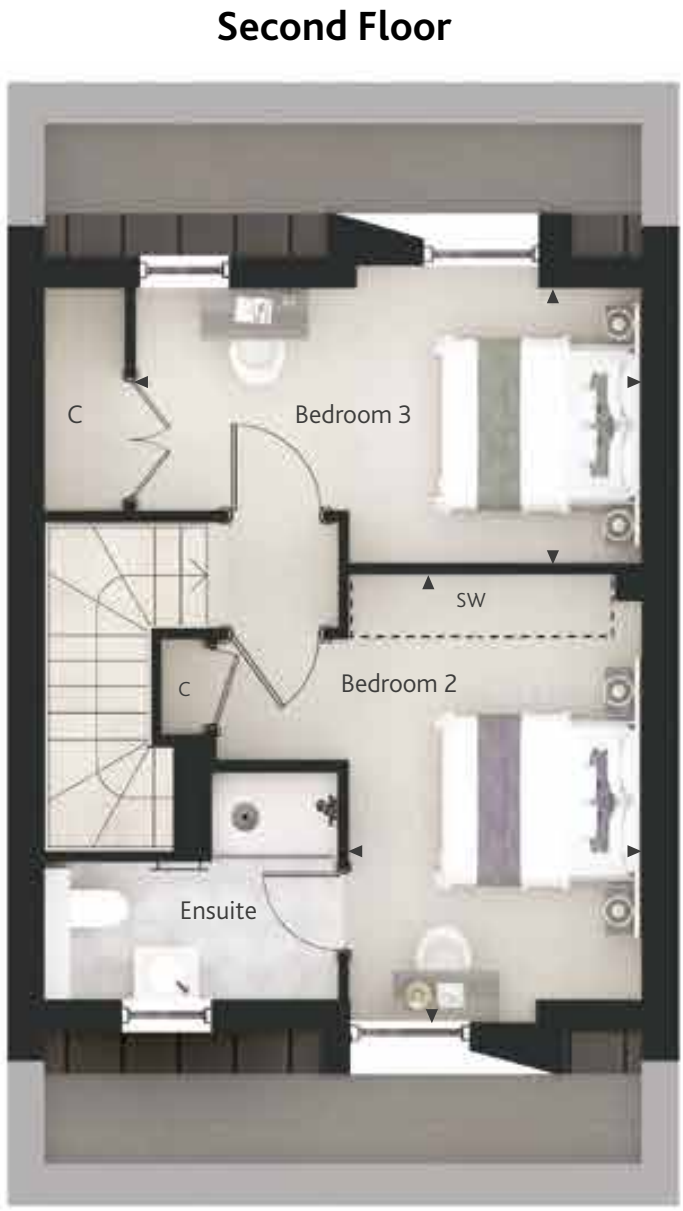

KEY

C - Cupboard U - Utility Cupboard W - Wardrobe FF - Fridge Freezer OV - Oven SW - Space for Wardrobe WD - Washer Dryer RL - Rooflight HWC - Hot Water Cylinder
J - Juliette Balcony SC - Services Cupboard MVHR - Mechanical VentilationHeat Recovery Unit